

REPUBLIQUE DU CAMEROUN
PAIX- TRAVAIL- PATRIE

MINISTERE DE LA DECENTRALISATION ET DU DEVELOPPEMENT
LOCAL

REGION DU NORD OUEST
DEPARTEMENT DE MEZAM
COMMUNE DE BAMENDA III
B.P Box 5012 Bamenda
Tel: (237) 6 77665180



REPUBLIC OF CAMEROON
PEACE- WORK-FAHERLAND

MINISTRY OF DECENTRALIZATION AND LOCAL DEVELOPMENT

NORTH WEST REGION

MEZAM DIVISION

BAMENDA III COUNCIL

B.P Box 5012 Bamenda
Tel: (237) 6 77665180

BAMENDA III COUNCIL INTERNAL TENDERS BOARD

BY EMERGENCY PROCEDURE

REQUEST FOR QUOTATION DOCUMENT

**N° 003/RQ/BIIC/BIICITB/PNDP/2020 OF 29/07/2020 FOR THE
CONSTRUCTION & OPENING OF ROAD 750m (morihno store-madela
street) AND CONSTRUCTION OF 11 RC BOX CULVERTS AT UPPER BAYELLE
QUARTER IN BAMENDA III COUNCIL AREA, MEZAM DIVISION OF THE
NORTH WEST REGION OF CAMEROON**

Latest dates to submit the bids	19/08/2020, at 10:00a.m
Bids Opening dates	19/08/2020, at 11:00a.m

Table of Contents

QUOTATION LETTER.....	4
NOTICE BOARD MODEL	6
COUNCIL PROJECT 'WORK'	7
INVITATION LETTER	8
SUBJECT: INVITATION TO QUOTE	9
INSTRUCTION TO BIDDERS.....	10
CONDITIONS FOR THE QUALIFICATION	17
CAUTION	18
MODEL FORMS USED TO CONSTITUTE A QUOTATION	20
TASK DESCRIPTION AND UNIT PRICE.....	22
DECLARATION OF QUALIFICATION	25
FORM C.1. PRESENTATION OF THE FIRM	26
DECLARATION OF NON EXCLUSION/SUSPENSION BY ARMP	28
CURRICULUM VITAE OF THE HEAD TECHNICAL MANAGER DESIGNATED FOR THE MANAGEMENT OF THE PROJECT	30
LETTER OF ORDERS.....	32
ANNEX 1.....	39
ENGAGEMENT LETTER.....	39
ANNEX 2.....	41
CORRECTED SUBMISSION LETTER.....	41
ANNEX 3.....	43
QUANTITIES AND COST ESTIMATES.....	43
MODEL FOR PERSONNEL AND MATERIAL MEANS.....	51
II. EQUIPMENT	52

TECHNICAL FILE.....	53
THE TECHNICAL FILE IS JOINTLY PRESENTED AND CONSTITUTES PART OF THE REQUEST FOR QUOTATION.....	54
SPECIAL TECHNICAL SPECIFICATIONS.....	55
1.1. EXECUTION OF WORKS	56
CONSTRUCTION PHASE	59
QUALITY AND QUANTITY CONTROL.....	59
ENVIRONMENTAL CONSIDERATIONS.....	59
A. SECURITY.....	59
B. DISPOSAL OF WASTE MATERIAL AND CLEANING OF SITES	59
CONTROLE PHASE	63
OBSERVATIONS OR RECOMMENDATIONS FOR THE WORKS REALIZED DAILY.	63
RECEPTION PHASE.....	63
SCHEDULE OF UNIT PRICES.....	67
DETAIL PRICE BREAKDOWN.....	71
MODEL OF ENGAGEMENT OF THE TENDERER	73
PLANS AND DRAWINGS.....	82

QUOTATION LETTER

QUOTATION LETTER

NAME OF BIDDER	
DATE	
PROJECT TITLE	THE CONSTRUCTION & OPENNING OF ROAD 750m (morihno store-madela street) AND CONSTRUCTION OF 11 RC BOX CULVERTS AT UPPER BAYELLE QUARTER IN BAMENDA III COUNCIL AREA, MEZAM DIVISION OF THE NORTH WEST REGION OF CAMEROON
REFERENCE OF THE REQUEST FOR QUOTATION	N ⁰ 001/RQ/BIIC/BIICITB/PNDP/2020 OF 29/07/2020

The Mayor of Bamenda III Council,

Subject: QUOTATION LETTER

Dear Sir,

After having examined the Request for Quotation file referenced above, we, the undersigned, propose to carry out the described work in conformity with all the conditions and specifications of the technical file (the general and particular technical specifications, the descriptive and quantitative bills) for a total, all taxes inclusive of:

Amount (in figures)..... (in words)frances including all taxes and within the completion period in your Request for Quotation Letter.

The following documents form an integral part of our Bid:

- 1) The present Quotation Letter established according to the model, dated and signed;
- 2) The Descriptive and Quantitative Form duly filled, dated and signed;
- 3) The Schedule of Unit Prices;
- 4) The Declaration of Qualifications according to the model, dated and signed;
- 5) The Draft Contract initialled on each page;
- 6) Other essential documents

Through your participation in the present tendering procedure, we accept all the conditions of the selection procedure defined in the Request for Quotation file, and declare that our offer takes into account work access and execution conditions. We understand that you are not held to award a contract at the end of this procedure.

We engage ourselves on the terms of this period for a period of 150 Days as from the date fixed for the opening of bids, as stipulated in the Request for Quotation Letter. The offer will continue to engage us and could be accepted at any time before the end of this period.

THE GENERAL MANAGER

NOTICE BOARD MODEL

REPUBLIQUE DU CAMEROUN
PAIX- TRAVAIL- PATRIE

MINISTRE DE LA DECENTRALISATION ET DU DEVELOPPEMENT
LOCAL

REGION DU NORD OUEST
DEPARTEMENT DE MEZAM
COMMUNE DE BAMENDA III

B.P Box 5012 Bamenda
Tel: (237) 6 77665180



REPUBLIC OF CAMEROON
PEACE- WORK-FAHERLAND

MINISTRY OF DECENTRALIZATION AND LOCAL DEVELOPMENT

NORTH WEST REGION

MEZAM DIVISION

BAMENDA III COUNCIL

B.P Box 5012 Bamenda
Tel: (237) 6 77665180

COUNCIL PROJECT 'WORK'

PROJECT NAME	CONSTRUCTION & OPENNING OF ROAD 750m (morihno store-madela street) AND CONSTRUCTION OF 11 RC BOX CULVERTS AT UPPER BAYELLE QUARTER IN BAMENDA III COUNCIL AREA, MEZAM DIVISION OF THE NORTH WEST REGION OF CAMEROON
VILLAGE AND QUARTER	UPPER BAYELLE, NKWEN VILLAGE
PROJECT NUMBER	003/MINDDEVEL/BIHC/PNDP-NW/STUDIES/2020
DURATION	04 MONTHS (120 DAYS)

A request for quotation including the bidding conditions, a description of works and envisaged contracting conditions is placed by the MAYOR OF BAMENDA III COUNCIL at the disposal of all qualified firms and enterprises interested in the execution of the above mentioned works. The requests for quotation file can be obtained **FREE OF CHARGE** from the BAMENDA III Council Secretariat at Bamenda, MEZAM Division from 29/07/2020, during the working days, between 7:30 AM and 3:00 PM.

The participation to this call for competition is opened to companies having submitted a file for pre-qualification and are recorded by the PNDP Regional Coordination Unit in the following fields of intervention: **CONSTRUCTION AND PUBLIC WORKS**.

The participation in this call to competition is also opened to all companies able to comply with the administrative qualifications conditions as well as technical and financial conditions as defined in the request for quotation.

Latest dates to submit the bids	19/08/2020, at 10:00a.m
Bids Opening dates	19/08/2020, at 11:00a.m

The Mayor, BAMENDA III Council

29 JUL 2020

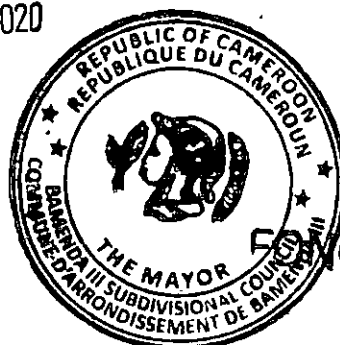

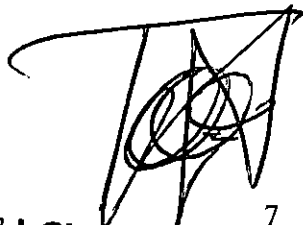
FONGU Cletus TANWE

INVITATION LETTER



REPUBLIQUE DU CAMEROUN
PAIX- TRAVAIL- PATRIE

MINISTERE DE LA DECENTRALISATION ET DU DEVELOPPEMENT
LOCAL

REGION DU NORD OUEST

DEPARTEMENT DE MEZAM

COMMUNE DE BAMENDA III

B.P Box 5012 Bamenda
Tel: (237) 6 77665180



REPUBLIC OF CAMEROON
PEACE- WORK-FAHERLAND

MINISTRY OF DECENTRALIZATION AND LOCAL DEVELOPMENT

NORTH WEST REGION

MEZAM DIVISION

BAMENDA III COUNCIL

B.P Box 5012 Bamenda
Tel: (237) 6 77665180

Ref. No./MINDDEVEL/NWR/MD/BIISD/BIIC/....

BAMENDA III , the.....

The Director of:

-
-
-

SUBJECT: INVITATION TO QUOTE

PROJECT NAME	CONSTRUCTION & OPENNING OF ROAD 750m (moriho store-madela street) AND CONSTRUCTION OF 11 RC BOX CULVERTS AT UPPER BAYELLE QUARTER IN BAMENDA III COUNCIL AREA, MEZAM DIVISION OF THE NORTH WEST REGION OF CAMEROON
VILLAGE AND QUARTER	UPPER BAYELLE QUARTER, NKWEN VILLAGE
PROJECT NUMBER	003/MINDDEVEL/BIIC/PNDP-NW/STUDIES/2020
DURATION	04 MONTHS (120 DAYS)

Madam, Sir,

Within the framework of the National Community Driven Development Program (PNDP), the BAMENDA III council has obtained an allocation from PNDP and considers using part of it for the **CONSTRUCTION & OPENNING OF ROAD 750m (moriho store-madela street) AND CONSTRUCTION OF 11 RC BOX CULVERTS AT UPPER BAYELLE QUARTER IN BAMENDA III COUNCIL AREA, MEZAM DIVISION OF THE NORTH WEST REGION OF CAMEROON**. You are hereby invited to submit your best offer for the execution of the aforesaid works.

A request for quotation file including the bidding conditions, a description of work as well as a sample contract to be used is placed at your disposal by council. The quotation file can be **FREE OF CHARGE** from the **29/07/2020**, during the working days, between **7:30 AM** and **3:00 PM** and the deadline of reception of the offers is fixed on **19/08/2020**, at **10:00.AM**. While counting on your usual participation, accept our sincere greetings.

The Mayor, BAMENDA III
Council

29 JUL 2020

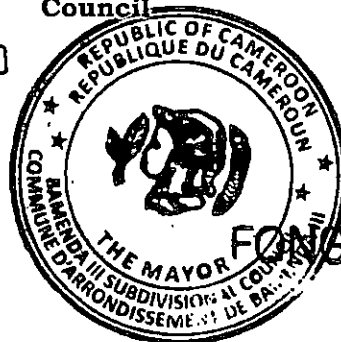

FONKU Cletus TANWE

INSTRUCTION TO BIDDERS

1. Contents of the Request for Quotation

This request for quotation described the work subject to the contract, establishes the bid submission conditions, the attribution rules and stipulates the conditions of contract applicable to the bid. Through its participation, the Bidder acknowledges having reviewed and accepted the instructions, conditions and specifications contained in the request for quotation.

2. Bidding Language

The bid, and all the documents constituting it, must be compiled in English or French language.

3. Elements of an admissible tender

To be admissible, the offer must be established with one (01) original and six (06) copies, and include the following elements:

- 1) The Quotation letter established according to the following model: IV, A), dated and signed;
- 2) The quantitative and estimated form completed (model IV, B), dated and signed;
- 3) The statement of Qualifications (following the model IV, C), applicable to non-already registered providers;
- 4) Draft contract, initialled on each page (following the model IV, D);
- 5) Other key documents (attestation of the site visit and site visit report).

4. Bid Currency

The bidding prices will be given in CFA Francs.

5. The bid validity Period

The offer will remain valid for a period of 90 (ninety) calendar days.

6. The conditions of filing of offers

6.1. The bidder shall place the original and six(06) copies of its offer in a sealed envelope and addressed it to the **Mayor** using the address indicated in the Request for Quotation.

6.2. The sealed envelope will bear the title of the project with the mention ***"To be open only in the presence of the Council Internal Tenders Board"***.

7. Date and time limit for filing of tenders

Bids must be received at the address shown on the request for quotation, on or before the date and time set in the request for quotation. Any offer presented after the set time will not be open and will be returned to the bidder.

8 Opening of tenders

8.1. Bids will be open during a Council internal tender board session in the presence of representatives of bidders wishing to attend on the date and time at the address specified in the request for quotation letter.

8.2. The names of bidders and amounts of the offers will be read aloud and will be recorded by the Secretary of the Council internal tender's board, in minutes of opening of the bids.

9. Evaluation of tenders

The Council tender board members will evaluate the offers and may if necessary appoint an expert in the field to accompany them in the analysis. The evaluation of tenders will be conducted in the following order:

- a. Verification of the conformity of administrative documents to avoid any failures at the time of attribution;
- b. Verify that the Letter of Quotation is well filled, dated and signed with the name and function of the signatory;
- c. Verify that the Descriptive and Quantitative Forms are duly filled, dated and signed;
- d. Verification of the arithmetic operations, if necessary multiplying unit prices by the quantities and by using the price in words to carry out necessary corrections;
- e. To work out a quotation summary table based on the corrected amount and ranked in ascending order;
- f. Checking in the offer classified file, of Declaration of Qualifications according to the imposed model;
- g. Verify the qualification of the bidder by comparing his declaration with the minimum requirement of qualification given in Chapter III of the present request for quotation.

If the lowest Bidder's bids ranked in the summary table are checked to satisfy the minimal conditions imposed for qualifications, the Council internal Tender's Board will propose him as provisional contractor to the Mayor of BAMENDA III Council, Contracting Authority.

If the lowest Bidder's bid does not satisfy the imposed minimal conditions of qualification, the offer will be eliminated and the Council internal Tender Board will carry out the examination of the offer of the second bidder in the ranking summary table. This procedure can be repeated in the event of incomplete offers or unqualified bidders.

The Council internal Tender Board will draw up a detailed final evaluation report with a recommendation to the Mayor (contracting Authority) for the provisional attribution of the Bid.

EVALUATION GRID OF THE CONTRACTORS OFFERS

APPRAISAL GRILL FOR THE CONSTRUCTION & OPENNING OF ROAD 750m (morihno store-madela street) AND CONSTRUCTION OF 11 RC BOX CULVERTS AT UPPER BAYELLE QUARTER IN BAMENDA III COUNCIL AREA, MEZAM DIVISION OF THE NORTH WEST REGION OF CAMEROON				
N°	CRITERIA	CONFORMITY		OBSERVATIONS
		YES	NO	
REFERENCES OF THE COMPANY				
1	Minimum two (02) registered contract in <i>EARTH ROADS</i> for the past 03 years (1st and last pages) certified by a competent authority			
2	Minimum two (02) PV of reception corresponding to the-joint contracts certified by a competent authority			
PERMANENT OR HIRED EQUIPMENTS				
3	Proof of Camion (own or hire)			
4	Proof of water tanker(own or hire)			
5	Proof of grader(own or hire)			
6	Proof of compactor(own or hire)			
7	Proof of front end loader(own or hire)			
8	Proof of a vehicle (Pick up 4 x 4 or van) (own or hire)			
9	Proof of Concrete Mixer good operating condition (own)			
10	Proof of a Concrete vibrator in good operating condition (own)			
11	Proof of a Manual Compactor in good operating conditions (own or hired)			
12	Proof of Small construction tools (own) and must be exhaustive (carpentry tools, building tools, iron bending tools etc)			
QUALIFICATION OF SITE PERSONNEL				
13	Organizational Chart of the company			
14	Organizational Chart for the site with comments			
15	WORKS DIRECTOR (Civil or Rural Engineer with at least 05 years of experience in similar works) who must be registered in the NATIONAL ORDER OF CIVIL or RURAL ENGINEERS			
16	Presentation of the Original of the Diploma of Work Director signed by the SDO or the Governor			
17	Certified Copy of Certificate of Works Director by Competent Authority			
18	CV signed and dated by the works Director with photo of concern attached on the top right of the CV			
19	Certified Copy of National ID Card of Works Director with signature signed three times on the certified copy			
20	SITE FOREMAN (at least Senior Civil or Rural Engineering Technician with at least 05 years of experience in similar works)			
21	Certified copy of certificate of Foreman			
22	CV signed and dated by the site foreman with photo of concern attached on the top right of the CV			
23	Certified copy of National ID Card of site foreman			

	<i>with signature signed three times on the certified copy</i>			
24	<i>Presentation of the Original of the Diploma of foreman signed by the SDO or the Governor</i>			
METHODOLOGY OF INTERVENTION AND EXECUTION OF THE WORKS				
25	<i>Attestation of site Visit signed by the Contractor</i>			
26	<i>Site Visit report with at least three pictures of remarkable spots on the site</i>			
27	<i>Detailed technical note concerning the organisation and the execution of works</i>			
28	<i>Planning of execution of works</i>			
29	<i>Respect of the duration of work</i>			
30	<i>Description of safety measures at the building site</i>			
31	<i>Description of socio - environmental measures for the protection the site</i>			
32	<i>Coherence in the execution of works</i>			
33	<i>Coherence in the organisation of the site</i>			
34	<i>CCTP dully initialled on each page and signed and dated on the last page</i>			
CAPACITY OF SELF-FINANCING				
35	<i>Attestation of credibility Minimum 25% of the bid price in F CFA</i>			
GENERAL PRESENTATION OF THE BIDS				
36	<i>Presence of all the documents</i>			
37	<i>Properly spiral bind</i>			
38	<i>Table of content</i>			
39	<i>Page separators in colour apart from white both in Original and Copies</i>			
40	<i>Order prescribed respected</i>			
41	<i>Clearness of the documents</i>			

N/B: Only bidders who score at least 80% YES on the above given evaluation grid shall be considered to be technically qualified and therefore their financial file can be examined. If found the lowest feasible bidder, it can be recommended to the Contracting Authority for the award of the contract.

10. The Bid Attribution

10.1. The Contracting Authority (Mayor of BAMENDA III Council) will invite the provisional contracting Bidder selected to present his administrative documents within 15 days. The administrative file shall include:

- a. the taxpayer card;
- b. Attestation of Business registration
- c. Attestation to prove that bidder is current with taxes;
- d. the certificate of imposition;
- e. A certificate from ARMP of non-exclusion from public contracts;
- f. A certificate of non-bankruptcy from the Court of the Jobbingity where the company is based;
- g. A Certificate attesting that the bidder is in order with his social security contributions signed by Regional chief of centres CNPS or a representative ;
- h. These certificates shall be dated less than three months;
- i. An attestation and plan of Jobbingization of the bidder.

j. In addition, the mayor will invite the provisional contractor to present the technical documents (ex: personnel means, equipment and material...) for good execution of the project (see point V).

10.2. Provided with these certificates, the Mayor, (Contracting Authority), will prepare the final minutes of attribution indicating that he has received a satisfactory administrative file that confirms the recommendation for attribution which was made to him by the Council Tender Board.

10.3. If the bidder declared provisional winner cannot constitute a satisfactory administrative file, **within 15 days**, the MAYOR, Contracting Authority, will establish an official report confirming the failure of the Bidder to present his administrative document and will forward it to the Chairman of the Council Tender Board which will have to meet again and submit an amended evaluation report, justifying rejection of the offer initially selected, and establishing a new recommendation in conformity with the evaluation.

10.4. If the, Contracting Authority, does not accept the recommendation of attribution of the Council Tender Board, he will prepare minutes justifying his refusal on objective basis and forward it to the Chairperson of the Council Tender Board which will have to meet again. In case of disagreement on the conclusions of the evaluation and the selection of the bidder, the ARMP will have to rule.

10.5 Before the contractor selected is invited to sign his contract, the result of the analysis of the offers and the proposal for an attribution of the **Contracting Authority** will be forwarded in writing to PNDP for NON OBJECTION for a duration not exceeding 7 days.

10.6. Within 90 DAYS following the date of reception of the offer, the contractor selected will be invited to sign a contract according to the model and the conditions presented in the present request for quotation file.

11. Corruption and fraudulent practices

The Mayor, his representatives, the Members of the Council Tender Board and the bidders, must observe in any circumstances professional strict rules of ethics. They must in particular avoid any corruption or any other form of fraudulent practice. On the bases of this principle, the expressions above are defined as follows;

a) "corrupt practice" is the offering, giving, receiving, or soliciting, directly or indirectly, of anything of value to influence improperly the actions of another party;

1

b) "fraudulent practice" is any act or omission, including misrepresentation, that knowingly or recklessly misleads, or attempts to mislead, a party to obtain financial or other benefit or to avoid an obligation; 2

¹ For the purpose of this sub-paragraph, "another party" refers to a public official acting in relation to the selection process or contract execution. In this context "public official" includes World Bank staff and employees of other organizations taking or reviewing selection decisions.

c) “collusive practices” is an arrangement between two or more parties designed to achieve an improper purpose, including to influence improperly the actions of another party 3;

d) “coercive practices” is impairing or harming, or threatening to impair or harm, directly or indirectly, any party or the property of the party to influence improperly the actions of a party 4;

e) “obstructive practice”

f) “(aa) ” deliberately destroying, falsifying, altering, or concealing of evidence material to the investigation or making false statements to investigators in order to materially impede a Bank investigation into allegations of a corrupt, fraudulent, coercive, or collusive practice; and/or threatening, harassing, or intimidating any party to prevent it from disclosing its knowledge of matters relevant to the investigation or from pursuing the investigation, or

g) “(bb) ” acts intended to materially impede the exercise of the Bank’s inspection and audit rights provided for under paragraph below.

² For the purpose of this sub-paragraph, “party” refers to a public official; the terms “benefit” and “obligation” relate to the selection process or contract execution; and the “act or omission” is intended to influence the selection process or contract execution.

³ For the purpose of this sub-paragraph, “parties” refers to participants in the procurement or selection process (including public officials) attempting either themselves, or through another person or entity not participating in the procurement or selection process, to simulate competition or to establish contract prices at artificial, non-competitive levels, or are privy to each other’s bid prices or other conditions.

⁴ For the purpose of this sub-paragraph, “party” refers to a participant in the selection process or contract execution.

CONDITIONS FOR THE QUALIFICATION OF ENTERPRISES

CAUTION

Bidders registered for their qualifications following the PNDP advertisement of 2017 for the prequalification of companies, are exempted to submit a declaration of administrative, technical, and financial qualification.

The Bidders not yet registered in PNDP registries are authorized to tender, but they must then include in their bid, a declaration of qualification established according to the models hereafter, applicable to the administrative, technical and financial conditions. These declarations will be checked for their exactitude. In the event of misrepresentation, the bidders bid will be rejected and notification will be addressed to ARMP for the possible application of sanctions.

The works subject to the request for quotation are part of the following fields of intervention:

CONSTRUCTION AND PUBLIC WORKS

The table below lists the documents and information to be submitted and explain how this information will be used to assess the administrative admissibility and the satisfaction of the technical and financial qualifications.

INFORMATION TO BE SUBMITTED		Form To use	CONDITIONS TO SATISFY	
Administrative Information			Administrative Conditions to be satisfied	
1	Presentation of the firm <ul style="list-style-type: none">• Statutes of the company, date of incorporation• Physical Location• Postal address• Names, titles, telephone Number, email• Name and title of the person authorized to sign a quotation• Tax identification number• Banking Information	C.1 form. C.2 form. C.3 form.	<ul style="list-style-type: none">• To have filled correctly and completely the information requested in the form• Not to have had a terminated contract or to have given up a building site within the framework of the PNDP during the last 3 years	<ul style="list-style-type: none">• To have joined the required documents, including their declarations on the honour according to the models presented
2	Declarations to be joined <ul style="list-style-type: none">• Plan of Jobbing/registration• Commercial registration• Business License• Chart of U.S.• Certificate of non-tax royalty• Certificate of CNPS• Declaration on the honour of no bankruptcy• Declaration on the honour of no exclusion by ARMP• Banking certificate• For electrification contracts with <i>ABS SONEL or the water connection with CAMWATER</i>:<ul style="list-style-type: none">• Certificate of approval of <i>ABS SONEL or CAMWATER</i>			
3	Declaration of the firm experience	C.4 form. (Table)	<ul style="list-style-type: none">• To have carry out at least 2 similar experiences within the last 3 years• To have joined copies of the Certificates of Provisional Reception (and/or final) of the completed similar projects	Technical Qualification Conditions
4	Qualifications of the management personnel of project	C.5 form. (CV)	<ul style="list-style-type: none">• To have at least one of the following qualifications:<ul style="list-style-type: none">• Civil or Rural Engineering diploma + 05 years of experiences in company, or• Senior Civil or Rural Engineering technical diploma + 5years of experiences in project management in company, or• Management experiences in the capacity as project manager of more than 5 projects of the same field	Financial Qualification Conditions
5	Declaration of contract amounts of the projects listed in the declaration of experiment (# 3 above)	C.4 form. (provided amounts of contract with the listed projects)	<ul style="list-style-type: none">• The total T of the C.4 Form, divided by the number of delivered listed projects, during the financial year (between 2 and 5)	Financial statements

**MODEL FORMS USED TO CONSTITUTE A
QUOTATION**

NAME OF BIDDER	
DATE	
NAME TITLE:	
REFERENCE OF THE REQUEST FOR QUOTATION	

The LORD MAYOR BAMENDA III COUNCIL

Subject: QUOTATION LETTER

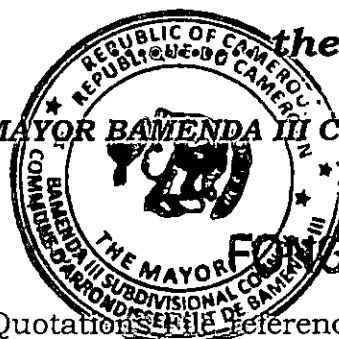

FONGU Cletus TANWE

Dear Sir, Madam,

After having examined the Request for Quotations ^{the,.....} referenced above, we, the undersigned, propose to carry out described work, in conformity with all the conditions and specifications of the technical file (the general and particular technical specifications, the descriptive and quantitative bills) for a total all taxes Inclusive ofFrancs CFA and within the completion period imposed in your Request for Quotation Letter.

The following documents form integral part of our Bid:

- 1) *The present Letter of Quotation established according to the model, dated and signed;*
- 2) *The Descriptive and Quantitative Form duly filled, dated and signed;*
- 3) *The schedule of unit price;*
- 4) *The declaration of qualifications according to the model;*
- 5) *The draft contract initialled on each page and signed on the last;*
- 6) *Other essential documents.*

Through your participation to the present tendering procedure, we accept all the conditions of the selection procedure, define in the request for quotation file, and declare that our offer takes into account work access and execution conditions. We understand that you are not held to award a contract at the end of this procedure.

We engage ourselves on the terms of this offer for a period of 90 days as from the date fixed for the bid opening, as stipulated in the Request for Quotations Letter. The offer will continue to engage us and could be accepted at any time before the end of this period.

The General Manager

TASK DESCRIPTION AND UNIT PRICE

SCHEDULE OF UNIT PRICES: THE CONSTRUCTION AND OPENNING OF ROAD AT UPPER BAYELLEQUARTER AND CONSTRUCTION 11 RC BOX CULVERTS ALONG THE ROAD (LENGHT = 750m)			
N°	DESIGNATION	U.P. in figs	U.P. IN WORDS
LOT 100	SITE PREPARATION AND STUDIES		
101	Site installation and geotechnical studies		
	This lump sum price include the cost of:		
	Preparing the site of equipment park and the project base of the enterprise;		
	Carrying out geotechnical penetrometre Studies relative to the construction of the bridge;		
	Provide and install 02 project information boards at each end of the project site;		
	A lump sum cost		
102	Mobilization and demobilization of equipment		
	This lump sum price include the cost of:		
	The cost of transporting all the equipment to the site ;		
	Mobilization of personnel;		
	Removal of all the equipment from site at the end of the project		
	A lump sum cost		
LOT 200	EARTHWORKS		
201	bulldozing		
	This price per unit include the cost of		
	bulldozing and clearing all grass and debris including any tree that is found on the stretch of road		
	The cutting down of trees of more than 25cm diameter and removing all the tree trucks along the road surface of the project		
	A unit cost		
202	mise en forme		
	This price per Km of road includes the cost of:		
	Grading the section of the road by scarification and moulding;		
	Cleaning of existing road side ordinary ditches and outlet to about 20m long		
	A kilometre (km) cost		
203	placing of surface coarse		
	This price per cubic meter include the cost of		
	Provision of selected material(laterite) from an approved borrow pit		
	Compaction of the material up to obtaining a compaction of 95%OPM in successive layers of 20cm;		

	A cubic meter (m3) cost *****		
LOT 300	DRAINAGE WORKS - STRUCTURES		
301	construction and installation of 11 box culverts		
	This price per metre length includes the cost of:		
	construction of 100cmx100cm RC box culverts, Digging or excavation of all trenches right to the resistant soil; Provision of selected material(laterite) from borrow, the complete construction of RC box culverts with dimensions as specified in the CCTP		
	A meter length (ml) cost		
302	Construction of masonry culvert heads including all accessories		
	This price per Km of road includes the cost of:		
	construction of masonry head culverts with cement mortar dosed at 350kg/m3		
	A kilometre (km) cost *****		
303	Construction of masonry gutters		
	This price per unit is the cost of:		
	Constructing masonry gutters with black stone masonry with respect to the plan dosed at 350kg/m3		
	A unit(u) cost		
401	Supply and install Labelisation boards		
	This price per unit is the cost of:		
	Constructing culvert manholes with black stone masonry with respect to the plan dosed at 350kg/m3		
	A unit(u) cost		
501	Sensitization of the management committee on the maintenance and risk hazards/planting of twenty (20) trees		
	This price per unit is the cost of:		
	Mobilisation of personnel and purchasing and planting of twenty environmental friendly trees		
	A unit(u) cost		

DECLARATION OF QUALIFICATION

FORM C.1. PRESENTATION OF THE FIRM

1	STATUS OF THE COMPANY	
2	DATE OF INCORPORATION	
3	TAXATION IDENTIFICATION No	
4	PHYSICAL ADDRESS	Street number: Town, Region
5	POSTAL ADDRESS	P.O box Town, Region
6	MANAGEMENT STAFF	Name, Telephone (S), Addresses electronic
	GENERAL MANAGER	
	TECHNICAL DIRECTOR	
	ADMINISTRATIVE DIRECTOR	
7	NAME, POSITION, OF THE PERSON AUTHORIZED TO SIGN A BID BELOW 30 MILLION FCFA	
8	BANKING INFORMATION	Name Address Account No.

9	SITUATION PLAN Visa by competent Authorities	
10	CERTIFICATE OF INCORPORATION	
11	BUSINESS LICENCE	
12	TAXPAYER's CARD	
13	TAX CLARANCE CERTIFICATE	
14	CNPS ATTESTATION	
15	DECLARATION ON the HONOR OF NO BANKRUPTCY	
16	ATTESTATION OF SOLVENCY	
17	DECLARATION ON the HONOR OF NOT EXCLUSION/SUSPENSION BY ARMP	
18	ATTESTATION OF SITES VISIT AND REPORT	
19	ATTESTATION OF BANK ACCOUNT	
20	FOR ELECTRIFICATION AND REHABILITATION OR EXTENSION OF CAMWATER WATER SUPPLY NETWORK CONNECTION TO AES SONEL JOIN A CERTIFICATE Of RECOGNITION FROM THESE CORPORATIONS.	

FORM C. 2. ATTESTATION OF SOLVENCY

....., ***the***.....

NAME OF THE BIDDER	
POSTAL ADDRESS	
ADDRESS PHYSICAL	

Dear Sirs,

We hereby declare on honour that at the date of the signature of this document, our company is not in situation of bankruptcy and we commit ourselves if we would be retained as provisional contractor for the implementation of this project, to submit within seven (7) days as you requested, a certificate duly sign by the competent authority and confirming this declaration.

The General Manager

FORM C. 3.
DECLARATION OF NON EXCLUSION/SUSPENSION BY
ARMP

....., *the*.....

NAME OF THE BIDDER	
POSTAL ADDRESS	
ADDRESS PHYSICAL	

Dear Sirs,

We hereby declare on honour that at the date of the signature of this document, our company is not in situation of exclusion, nor of suspension, by the Authorities of the Cameroun Public Contract Regulatory Board (ARMP).

We commit ourselves if we are retained as provisional contractor for the implementation of this project, submit within seven (7) days as you requested, a certificate duly sign by the competent authorities of ARMP confirming this declaration.

The General Manager

FORM C.4. EXPERIENCE OF THE FIRM

List contracts of the same domain of intervention, carried out during the last five years. Listed work must be provisionally received.

If the experience of the company covers several fields of intervention among the 5 fields covered by the PNDP, the declaration of the qualifications requires a distinct table of each of the domains of intervention. These fields are as follows:

1. BUILDINGS	<i>All sectors: education, health, markets, slaughter-houses, warehouses, buildings administrative,</i>
2. INSTALLATIONS PUBLIC EQUIPMENT	<i>Sporting complexes, parks, road stations, refuse tips</i>
3. EARTHWORKS & CIVIL ENGINEERING	<i>Rural roads, roadway systems, bridges, pedestrian, irrigated drainage, drainage system, thresholds, perimeters, stabilization of slope/banks.</i>
4. PUBLIC ELECTRIFICATION	<i>Equipment, sub-stations, transport, poses cables</i>
5. HYDRAULIC WORK	<i>Well, Bore holes, water catchment systems, water capturing</i>

AREA OF INTERVENTION:						
	<i>Name of the project</i>	<i>Client's name</i>	<i>Client contact Tel. No.</i>	<i>Amount of contract</i>	<i>Date signing contract</i>	<i>Date provisional reception</i>
1						
2						
3						
4						
5						
etc						
TOTAL				T =		

N.B.: Ensure that the copies of the certificates of provisional acceptance (and/or final) of each project listed above is attached.

FORM V.6.

CURRICULUM VITAE OF THE HEAD TECHNICAL MANAGER DESIGNATED FOR THE MANAGEMENT OF THE PROJECT

NAME	
FIRST NAME	
ADDRESS	
TELEPHONE NO.	

EDUCATION DIPLOMA	
NAME OF SCHOOL	

FIRST LANGUAGE	
-----------------------	--

EXPERIENCES

From Month / year To Month / year	Name, address from the employer
	Function occupied
	Project

From Month / year To Month / year	Name, address from the employer
	Function occupied
	Project

From Month / year To Month / year	Name, address from the employer
	Function occupied
	Project

From Month / year To Month / year	Name, address from the employer
	Function occupied
	Project

From Month / year To Month / year	Name, address from the employer
	Function occupied
	Project

From Month / year To Month / year	Name, address from the employer
	Function occupied
	Project

N.B.: Be sure to attach copies of diplomas, work certificates or contracts

FORM C.7. CERTIFICATE OF SITE VISIT

....., *the*.....

NAME OF THE BIDDER	
POSTAL ADDRESS	
ADDRESS PHYSICAL	

I the undersigned _____ Director/Engineer in charge
of _____ for
_____ company attest to have visited the project
site _____ following the invitation to tender No.

As a result of this site visit, the following observations were made:

A) GENERAL OBSERVATIONS

- 1) .
- 2) .
- 3) .
- 4) .
- 5) .
- 6) .

B) SPECIFIC OBSERVATIONS

- 1) .
- 2) .
- 3) .
- 4) .
- 5) .
- 6) .

The General Manager

LETTER OF ORDERS

Awarded after Request for Quotation

N° 003/RQ/BIIC/BIICITB/PNDP/2020 OF 29/07/2020

FOR THE CONSTRUCTION & OPENNING OF ROAD 750m (morihno store-madela street) AND CONSTRUCTION OF 11 RC BOX CULVERTS AT UPPER BAYELLE QUARTER IN BAMENDA III COUNCIL AREA, MEZAM DIVISION OF THE NORTH WEST REGION OF CAMEROON

CONTRACTOR:

ETS

BP:

Tel.

TAX PAYER'S N°

BANK ACCOUNT N°

.....

SUBJECT: THE CONSTRUCTION & OPENNING OF ROAD 750m (morihno store-madela street) AND CONSTRUCTION OF 11 RC BOX CULVERTS AT UPPER BAYELLE QUARTER IN BAMENDA III COUNCIL AREA, MEZAM DIVISION OF THE NORTH WEST REGION OF CAMEROON

AMOUNTS:

TOTAL AMOUNT WITHOUT TAXES (MHT)	
VAT (19,25%) * MHT	
IR (2,2% OR 5,5%) * MHT	
TOTAL AMOUNT WITH TAXES INCLUDED (MHT + TVA)	
NET AMOUNT TO BE PAID	

CONTRACT DURATION: (04) Months

FUNDING: PNDP FUNDS/ BAMENDA III COUNCIL BUGET 2020

SUBSCRIBED ON THE:.....

SIGN ON THE:.....

NOTIFIED ON THE:.....

REGISTERED ON THE:.....

CHAPTER I: GENERALITIES

✚ **Article 1 : Objective of the Jobbing Order (JO)**

The present Jobbing Order (JO) is **FOR THE CONSTRUCTION & OPENNING OF ROAD 750m (morihno store-madela Street) AND CONSTRUCTION OF 11 RC BOX CULVERTS AT UPPER BAYELLE QUARTER IN BAMENDA III COUNCIL AREA, MEZAM DIVISION OF THE NORTH WEST**

REGION OF CAMEROON'

The description of this works is indicated in article 10 hereafter.

✚ **Article 2 : Implementation procedure of the Jobbing Order (JO)**

The present Jobbing Purchasing Order (JPO) is published according to the procedure laid down in the Request for Quotations.

✚ **Article 3 : Documents constituting the Jobbing Order (JO)**

The contractual documents constituting this Jobbing Order (JO) are by order of priorities as follow:

- (1) The present Jobbing Order (JO);
- (2) The quantitative and descriptive form;
- (3) The contractor bid and his financial proposals in all the non-contrary technical and administrative specifications imposed in the request of quotation.

✚ **Article 4 : Generalities**

The present Jobbing Purchasing Order (JPO) is subjected to the regulation in force as regards public contracts in Cameroun at the date of its signature.

✚ **Article 5 : Attributions of the Chief of Service and the Contract Engineer**

To apply the provisions of this Jobbing Purchasing Order (JPO), it is specified that **The Client is the Mayor of BAMENDA III Council**, while attributions of the Contract Engineer are exerted by the sector Head appointed for the contract.

✚ **Article 6 : Duration and place of works**

The duration is **FOUR (04) months** counting from the date of notification of this Jobbing Order (JO).

The location is in **UPPER BAYELLE QUARTER, NKWEN village in BAMENDA III Sub Division, MEZAM Division.**

✚ **Article 7 : Residence of the Contractor**

The Contractor is based in, **PO. Box:**

....., **Tel:**

CHAPTER II: EXECUTION OF THE JOBBING ORDER (JO)

✚ **Article 8 : Role and responsibility of the contractor**

The contractor's role is to ensure the realization of works as described in article 10 under the control of the Contract Engineer and this in accordance with the rules and Norms in force in Cameroun and the specifications of present Jobbing Purchasing Order (JPO) s.

✚ **Article 9 : Consistency of the services**

The services of the contractor include the construction of an administrative block, fenced slap for the livestock market and all the expenses related to technical reception and insurance.

✚ **Article 10: Description of works**

The services include **THE CONSTRUCTION & OPENNING OF ROAD 750m (morihno store-madela Street) AND CONSTRUCTION OF 11 RC BOX CULVERTS AT UPPER BAYELLE QUARTER IN BAMENDA III COUNCIL AREA, MEZAM DIVISION OF THE NORTH WEST REGION OF CAMEROON**

✚ **Article 11: Information and documents required by the contactor.**

✚ **Article 12: Reception of the works**

The Mayor will determine the date and the methods of the reception of the works which will be carried out in the presence of the Contactor by a reception commission.

The reception commission will be composed of the following members:

CHAIRPERSON: *The Mayor of Bamenda III Council or his representative;*

SECRETARY: *The Contract Engineer, Divisional Delegate of Public Works MEZAM*

MEMBERS:

- *The CDO Bamenda III Council*
- *The Controller;*
- *The PNDP Infrastructure Engineer ;*
- *The PNDP Regional Co-ordinator or her representative.*
- *The DD MINDDLEVEL.*

The quorum of the reception Commission is achieved by the presence of **2/3** of its members.

The contractor is convened at the reception as observer. He is required to attend or to be represented. His absence is equivalent to the total acceptance of the conclusions of the reception commission.

The reception Commission will check the conformity of the works/supply with the prescriptions contained in the Jobbing Order (JO).

In the event of nonconformity of the supply, the Contactor will be invited to replace at his expenses the rejected supply.

In the event of supply in conformity, the commission will pronounce the reception. A minute of reception signed by all the Members of the Commission and the Contactor will be prepared. This reception commission shall report on the quantity and quality of the material, the quality of the packaging and the respect of the contractual clauses.

✚ **Article 13: Guarantee**

The usual commercial guarantees mentioned in the general clauses and resulting from a defect or an early deterioration of the material are the responsibility of the Contactor.

✚ **Article 14: Insurance**

Risks of all natures during transport until the place of delivery must be covered by an insurance taken by the Contactor. The Mayor is free of any obligations or responsibility until reception of the works.

The insurance must represent a hundred and ten per cent (10%) of CAF value of the works "store to store" on an "all risks" basis, including strike and war risks, in a freely convertible currency. The Mayor must be designated as beneficiaries.

CHAPTER III: FINANCIAL PROVISIONS

✚ **Article 15: General information price**

The Contactor is reputed to have a perfect knowledge of all possible suggestions imposed for the execution of the services and of all the Jobbing conditions likely to influence this execution.

The prices of this Jobbing Order (JO) are firm and non-revisable. They obligatorily cover all the works, expenses, incidental expense and risks and are All Taxes Inclusive.

✚ **Article 16: Assembling letter orders**

The total amount of this Jobbing Order (JO) amount to the sum of XXX is in accordance with the quantities and cost estimates attached in appendix.

✚ **Article 17: Modalities of payment**

(1) Starting payment Advance

After notification of the contract to the contractor, an instalment corresponding to 20% of the amount of the Jobbing Order (JO), All Taxes Inclusive can be paid upon request to the holder of the contract.

This instalment is guaranteed hundred per cent (100%) by a class A bank approved by the Ministry in charge of Finances.

The guarantee is delivered upon reception of the works subject of the Jobbing Order (JO).

(2) Instalment Payments

The payments are done proportionately to the equipment's supplied and deductions are made from the previous payments. The contractor is paid on submission of his bills and after reception of the works.

✚ **Article 18: Banking domiciliation**

The Mayor will pay out the cost of the execution of present Jobbing Order (JO) by bank transfer at the account N° XXXXXXXXXXXXXXXXXXXXXXX located at the XXX.

✚ **Article 19: Tax system**

The present JPO is subjected to all the rights and taxes in force in the Republic of Cameroun.

✚ **Article 20: Stamp and registration**

Four (04) originals copies of present Jobbing Purchasing Order (JPO) are to be stamped and registered by the Contractor and at his expenses, in accordance with the regulation in force.

CHAPTER IV: OTHERS PROVISIONS

✚ **Article 21: Edition and diffusion of Jobbing order (JO)**

Seven (07) copies of the present Jobbing Order (JO) are published and diffused.

✚ **Article 22: Litigations**

Any litigation occurring between the contracting parts will be the subject of an amicable direct negotiation.

Any disagreement related to the present Contract, which the parties cannot regulate through amicable agreement shall be subject to arbitration in accordance with the laws of Cameroon.

✚ **Article 23: Cancellation of Jobbing Order (JO)**

The Present Jobbing Order (JO) can be cancelled under the conditions and forms envisaged by the regulation in force.

✦ **Article 24: Validity of Jobbing Order (JO)**

The Present Jobbing Order (JO) will be valid only after its signature by the Mayor and will come to effect only to its notification to the Contactor.

1. JO
2. JO
3. JO
4. JO
5. JO
6. JO
7. JO
8. JO
9. JO
10. JO
11. JO
12. JO
13. JO
14. JO
15. JO
16. JO
17. JO
18. JO
19. JO
20. JO
21. JO
22. JO
23. JO
24. JO
25. JO
26. JO
27. JO
28. JO
29. JO
30. JO
31. JO
32. JO
33. JO
34. JO
35. JO
36. JO
37. JO
38. JO
39. JO
40. JO
41. JO
42. JO
43. JO
44. JO
45. JO
46. JO
47. JO
48. JO
49. JO
50. JO
51. JO
52. JO
53. JO
54. JO
55. JO
56. JO
57. JO
58. JO
59. JO
60. JO
61. JO
62. JO
63. JO
64. JO
65. JO
66. JO
67. JO
68. JO
69. JO
70. JO
71. JO
72. JO
73. JO
74. JO
75. JO
76. JO
77. JO
78. JO
79. JO
80. JO
81. JO
82. JO
83. JO
84. JO
85. JO
86. JO
87. JO
88. JO
89. JO
90. JO
91. JO
92. JO
93. JO
94. JO
95. JO
96. JO
97. JO
98. JO
99. JO
100. JO

N° 003/RQ/BIIC/BIICITB/PNDP/2020 OF 29/07/2020

FOR THE CONSTRUCTION & OPENNING OF ROAD 750m (morihno store-madela street) AND CONSTRUCTION OF 11 RC BOX CULVERTS AT UPPER BAYELLE QUARTER IN BAMENDA III COUNCIL AREA, MEZAM DIVISION OF THE NORTH WEST REGION OF CAMEROON

CONTRACTOR:

ETS XXXXXXXXXXXXXXXXXXXXXXXXXXXX

BP:

Tel.

TAX PAYER'S N° XXXXXXXXXXXXXXXXXXXX

**BANK ACCOUNT N° XXXXX XXXXX XXXXXXXXXXXX XX
XXXXXXXXXXXXXXXXXXXXXXXXXXXXXXXXXXXX**

SUBJECT: CONSTRUCTION & OPENNING OF ROAD 750m (morihno store-madela street) AND CONSTRUCTION OF 11 RC BOX CULVERTS AT UPPER BAYELLE QUARTER IN BAMENDA III COUNCIL AREA, MEZAM DIVISION OF THE NORTH WEST REGION OF CAMEROON

AMOUNTS:

TOTAL AMOUNT WITHOUT TAXES (MHT)	
VAT (19,25%) * MHT	
IR (5,5/2,2%) * MHT	
TOTAL AMOUNT WITH TAXES INCLUDED (MHT + TVA)	
NET AMOUNT TO BE PAID	

**Done in seven (07) original copies at BAMENDA III COUNCIL,
the _____**

Approved by

The Contractor

The Regional Coordinator

PNDP NWR

**The Mayor,
Contracting Authority**

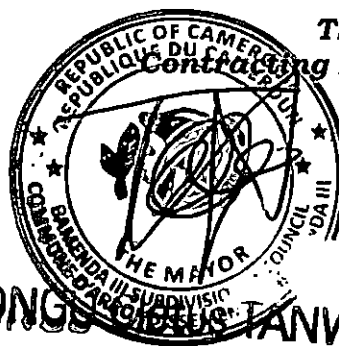

29 JUL 2020

ANNEX 1
ENGAGEMENT LETTER

ENGAGEMENT OF THE TENDERER

I the undersigned, **XXXXX XXXXXXXXXXX XXXXXXX**, acting by virtue of powers conferred on me, on behalf of the company, **ETS XXXXX XXXXXXXXXXXXXXX XXXXXXX** with Headquarters situated at..... Town,

After having taken knowledge of all the parts of the Request for Quotation

NO 003/RQ/BIIC/BIICITB/PNDP/2020 OF 29/07/2020

FOR THE CONSTRUCTION & OPENING OF ROAD 750m (morihno store-madela street) AND CONSTRUCTION OF 11 RC BOX CULVERTS AT UPPER BAYELLE QUARTER IN BAMENDA III COUNCIL AREA, MEZAM DIVISION OF THE NORTH WEST REGION OF CAMEROON

Subject to me and commits me to carry out the aforementioned Contract in accordance with the conditions of the Particular Payment of the Invitation to tender, the Book of the Particular Technical specifications and the Book of the Particular Administrative Clauses, in particular the quantitative and qualitative confirmation of work, the respect of the deadlines, the guarantees and the insurance.

I commit myself moreover to ensure the recording and paying the forwarding costs of the contractual parts.

I declare taking to have taken perfect knowledge of the decree n° 33/CAB/PM of February 13 2007 putting the general Administrative clauses applicable to the Contracts of public works and works.

I confirm my agreement on the terms of the Special Administrative Clauses (Draft contract) and join the initialled copy of the aforesaid document to my offer.

I declare moreover that I remain committed by the present tender during a ninety (90) days deadline as from the date of opening of the folds.

Done at _____, the _____

Read and approved

The CONTRACTOR

ANNEX 2
SUBMISSION LETTER

SUBMISSION LETTER

I the undersigned, **XXXXX XXXXXXXXXXXX XXXXXXXX**, acting by virtue of powers conferred on me, on behalf of the company, **ETS XXXXX XXXXXXXXXXXXXXX XXXXXXXX** with Headquarters situated at..... Town,

After having taken knowledge of all the parts of the Request for Quotation

NO 003/RQ/BIIC/BIICITB/PNDP/2020 OF 29/07/2020

FOR THE CONSTRUCTION & OPENING OF ROAD 750m (morihno store-madela street) AND CONSTRUCTION OF 11 RC BOX CULVERTS AT UPPER BAYELLE QUARTER IN BAMENDA III COUNCIL AREA, MEZAM DIVISION OF THE NORTH WEST REGION OF CAMEROON .

In the case where our offer would be accepted, I subject myself and I engage to carry out the aforementioned contract in accordance with the conditions of the Particular Payment of the Invitation to tender, the Book of the Particular Administrative Clauses and the Book of the Particular Technical specifications, at the prices indicated in the Schedule Price Unit, Quantitative and Cost Estimate, for the total amounts of the Offer into Francs CFA of:

- ✓ In Letter and figure (All Taxes Inclusive): **CFA Francs (Eight CFA Francs);**
- ✓ In Letter and figure (AIR 5,5% or 2,2%): **CFA Francs (..... CFA Francs);**
- ✓ In Letter and figure (Net to be paid): **CFA Francs (..... CFA Francs);**
- ✓ To pay the forwarding costs of the contractual parts.

To begin work within seven (07) maximum days and to carry out the contract within Four (04) months after the notification about Service Order to start work. The Building Owner will release himself from the sums which had by him under this contract while making give credit to the open account N° **located at the**

I declare taking to have taken perfect knowledge of the decree n° 33/CAB/PM of February 13 2007 putting the general Administrative clauses applicable to the Contracts of public works and works.

I confirm my agreement on the terms of the Book of the Particular Administrative Clauses (Draft contract) and join the initialled copy of the aforesaid document to my offer.

I declare moreover that I remained committed by the present tender during a ninety (90) days deadline as from the date of opening of the folds.

Done at _____, the _____

Read and approved

The Contractor

ANNEX 3
BILL OF QUANTITIES AND COST
ESTIMATES

**BILL OF QUANTITIES AND ESTIMATE FOR THE CONSTRUCTION AND OPENING OF
ROAD AT UPPER BAYELLE QUARTER AND CONSTRUCTION 11 RC BOX CULVERTS
ALONG THE ROAD (LENGTH = 750m)**

BILL OF QUANTITIES AND BUDGET ESTIMATE

N°	DESCRIPTION	UNIT	QTY	UNIT PRICES	TOTAL
LOT 100	SITE INSTALLATION AND PRELIMINARIES				
101	Site installation	LS	1.00		
102	Mobilisation and demobilisation of equipment	LS	1.00		
	SUB TOTAL LOT 100				
LOT 200	EARTHWORKS				
201	bulldozing	km	0.75		
202	mise en forme	km	0.75		
203	placing of surface coarse	m3	900.00		
	SUB TOTAL LOT 200				
LOT 300	DRAINAGE WORKS - STRUCTURES				
301	construction and installation of 11 box culverts	U	11.00		
302	Construction of masonry culvert heads including all accessories	U	16.00		
303	Construction of masonry gutters	lm	320.00		
	SUB TOTAL LOT 300				
LOT 400	EQUIPMENT ON THE ROAD				
401	Supply and install Labelisation boards	U	2.00		
	SUB TOTAL LOT 400				
LOT 500	ENVIRONMENTAL MITIGATIONS				
501	Sensitization of the management committee on the maintenance and risk hazards/planting of twenty (20) trees	U	1.00		
	SUB TOTAL LOT 500				
	TOTAL WITHOUT TAXES				
	V.A.T (19.25%)	%	19.25%		
	I.R(2.20%)	%	2.20%		
	TOTAL ALL TAXES INCLUDED				
	NET TO BE PAID				

SCHEDULE OF UNIT PRICES

**SCHEDULE OF UNIT PRICES: THE CONSTRUCTION AND OPENNING OF
ROAD AT UPPER BAYELLEQUARTER AND CONSTRUCTION 11 RC BOX
CULVERTS ALONG THE ROAD (LENGHT = 750m)**

N°	DESIGNATION	U.P. in figs	U.P. IN WORDS
LOT 100	SITE PREPARATION AND STUDIES		
101	Site installation and geotechnical studies		
	This lump sum price include the cost of:		
	Preparing the site of equipment park and the project base of the enterprise;		
	· Carrying out geotechnical penetrometre Studies relative to the construction of the the bridge;		
	· Provide and install 02 project information boards at each end of the project site;		
	A lump sum cost		
102	Mobilisation and demobilisation of equipment		
	This lump sum price include the cost of:		
	The cost of transporting all the equipment to the site ;		
	Mobilisation of personnel;		
	Removal of all the equipment from site at the end of the project		
	A lump sum cost		
LOT 200	EARTHWORKS		
201	bulldozing		
	This price per unit include the cost of		
	· bulldozing and clearing all grass and debris including any tree that is found on the stretch of road The cutting down of trees of more than 25cm diameter and removing all the tree trucks along the road surface of the project		
	A unit cost		
202	mise en forme		
	This price per Km of road includes the cost of:		

	<p>Grading the section of the road by scarification and moulding;</p> <p>Cleaning of existing road side ordinary ditches and outlet to about 20m long</p> <p>A kilometre (km) cost</p>		
203	<p>placing of surface coarse</p> <p>This price per cubic metre include the cost of</p> <p>Provision of selected material(laterite) from an approved borrow pit</p> <p>Compaction of the material up to obtaining a compaction of 95%OPM in successive layers of 20cm;</p> <p>A cubic meter (m3) cost</p>		
LOT 300	DRAINAGE WORKS - STRUCTURES		
301	<p>construction and installation of 11 box culverts</p> <p>This price per metre length includes the cost of:</p> <p>construction of 100cmx100cm RC box culverts , Digging or excavation of all trenches right to the resistant soil; Provision of selected material(laterite) from borrow, the complete construction of RC box culverts with dimensions as specified in the CCTP</p> <p>A meter length (ml) cost.....</p>		
302	<p>Construction of masonry culvert heads including all accessories</p> <p>This price per Km of road includes the cost of:</p> <p>construction of masonry head culverts with cement mortar dosed at 350kg/m3</p> <p>A kilometre (km) cost</p>		
303	<p>Construction of masonry gutters</p> <p>This price per unit is the cost of:</p> <p>Constructing masonry gutters with black stone masonry with respect to the plan dosed at 350kg/m3</p>		

	A unit (u) cost		
401	Supply and install Labelisation boards		
	This price per unit is the cost of:		
	· Constructing culvert manholes with black stone masonry with respect to the plan dosed at 350kg/m3		
	A unit (u) cost		
501	Sensitization of the management committee on the maintenance and risk hazards/planting of twenty (20) trees		
	This price per unit is the cost of:		
	· Mobilisation of personnel and purchasing and planting of twenty environmental friendly trees		
	A unit (u) cost		

DETAIL PRICE BREAKDOWN

Price No	Description	Daily out put	Total Quantity	Unit	Activities Duration
A - PERSONNEL	Category	Number	Daily Salary	Paid Mandays	Amount
			Total A		
B - EQUIPMENTS	Type	Number	Daily Rate	Days billed	Amount
			Total B		
C - MATERIALS	Type	Unit	Unit price	Consumption	Amount
D	Total Direct Cost		A + B + C		
E	General site expenses	10.00%	D x 10%		
F	General head office expenses	5.00%	D x 05%		
G	Cost price		D + E +F		
H	Risk + Profit	10.00%	G x 10%		
I	Bid Price without tax		G + H		
J	Unit Bid Price without tax		F/Total quantity		

MODEL FOR PERSONNEL AND MATERIAL MEANS

FORM C.5. STAFF

	NAMES	QUALIFICATION (diploma - training) (experience)	FUNCTION ON THE SITE
A. Administrative staff on the site			
B. Support staff			

	NUMBER
C. Masons	
D. specialized technician	

II. Equipment

II - 1 equipment and material for the execution of the work

DESIGNATION	NUMBER	AGE - STATE	ORIGIN	STATUS [2]

II - 2 small material and construction tools

DESIGNATION	NUMBER	AGE - STATE	ORIGIN

To,

The Contracting Authority

The bidder
(Name, first name, signature and stamp)

TECHNICAL FILE

The technical file is jointly presented and constitutes part of the request for quotation.

The technical file includes:

- The specifications of the General technical clauses or GTCC technology terms (applicable to all the work of the same domain)
- The specifications of the specific Technical Clauses or CCTP (specific to the micro-project subject to the application of rating)
- The estimated schedule of the amounts constituting the decomposition of global and lump-sum of the contract prices
- The schedule of unit prices
- Plans

SPECIAL TECHNICAL SPECIFICATIONS

SPECIAL TECHNICAL SPECIFICATIONS (CCTP)

1.0. GENERAL INFORMATIONS

Article 1: Subject

The present special Technical Clauses (CCTP) describes **THE CONSTRUCTION & OPENNING OF ROAD 750m (morihno store-madela Street) AND CONSTRUCTION OF 11 RC BOX CULVERTS AT UPPER BAYELLE QUARTER IN BAMENDA III COUNCIL AREA, MEZAM DIVISION OF THE NORTH WEST REGION OF CAMEROON**

Article 2: Extent of Works

These works are defined within the framework of the standards and references of Public works construction, under the general condition of ordering of work and the quantitative estimate of this offer.

1.1. EXECUTION OF WORKS

Article 3: Generalities:

This present special technical specifications concern **FOR THE CONSTRUCTION & OPENNING OF ROAD 750m (morihno store-madela street) AND CONSTRUCTION OF 11 RC BOX CULVERTS AT UPPER BAYELLE QUARTER IN BAMENDA III COUNCIL AREA, MEZAM DIVISION OF THE NORTH WEST REGION OF CAMEROON**

It is the duty of the contractor to realize the structure as per the execution plans approved by the competent authority and sample models of equipment and furniture provided by the project owner. Through the Project Controller, the contractor shall furnish the owner of the project and other team members within the shortest possible time an installation plan showing clearly how he intends to run the work site. A fence in Jobbing materials shall enclose the whole work site to avoid trespassing.

Sign Posts: The contractor shall put in place at his expense an information board indicating the works to be carried out and in conformity to the contract sign by the Contracting Authority.

A metallic board shall also be put up to indicate the type of works executed and following also the specifications of the contract signed

Hygiene and Safety: The contractor shall ensure total hygiene and security of the site by constructing a temporal pit latrine and putting up a temporal fence around the project site if that be the case. The contractor shall be responsible for the protection of the structures before final reception. He shall be equally responsible for all tools and materials present at the work site. He shall seek an insurance policy to cover theft and fire incidence. The contractor shall take preventive measures against accidents. The owner of the project reserves the right to intervene in case of any emergency without necessary interfering with the responsibilities of the contractor. The contractor shall verify all dimensions on the plans. For execution no dimension shall be measured with a scale rule from the plans. The contractor shall check in-situ the possibility of

translating the dimensions on plans to the structure before work begins. He shall refer to the Project Controller or Project Engineer in case of any doubt. He shall not on his own modify anything on the structure and shall inform the Project Controller or Project Engineer of any changes that he considers necessary. All modifications accepted by the contractor shall be accomplished in a specified duration and at his cost without modification of the contract amount. The owner of the project shall have the right to the final choice in case of any modification.

Article 4: Studies

The contractor in charge of this execution must make careful studies of the working drawings. Visit the site and bring up points not understood to the site supervisor for a clarification before tendering for the project, and making sure he understands everything for accepting to go in for this project and before setting out is carried out.

He will proceed to a careful study of the project and make observations and furnished modifications to the contract and control engineer before commencement of work. All supplementary tasks must be verified and signed by the supervisor. Careful studies must be done before commencement of foundation..

Article 5: Execution Documents

Before the execution of the project, the contractor must present to those concerned (Controller and Contract Engineer) a **site log book, site minutes book, and a Program of Work** which shall be validated and not leaving out a copy of his **registered contract**. The **Working Drawing (Plans)** shall be presented to the contractor and no modifications shall be done by the contractor without the approval of the controller in collaboration with the contract engineer.

After the realization of this project, the production of a **Report of Execution** is also an essential document the contractor needs to produce and submit for the validation by the controller and the contract engineer

Article 6: Mobilization, Site Installation and Implantation of the Project

a. Mobilisation of resources

This aspect concern the mobilization of both human and material resources necessary for the execution of the project, clearing of the site and evacuation of the rubbles to the public discharge, the clearing and levelling of the site where necessary.

b. Site installation of the work site.

The site installation of the said project shall entail the following:

- * The construction of a provisional fence;

- * Provision and installation of project signboards on positions indicated by the project controller. These building site signboards will carry the following indications
- * Provisional water connections, electricity and telephone
- * Necessary measures for the respect of legal/lawful provisions relating to hygiene and safety on site. (Installation of a latrine, provision of drinkable water, provision of a first aid box equipped with products such as: aspirin, nivaquine, adhesive plaster, bétadine, bands, compress, alcohol...);
- * A store room on site;
- * A site office, where the site book, the building plans will be available permanently throughout all realization of works;
- * An office or room of at least of 8 m² equipped with a table office and two chairs reserved with the Project superintendent;
- * A meetings room for the building site which can receive at least 5 people equipped with a table, two benches of 1.5 m, a display board for plans and planning placed permanently.

Receptacles to receive waste are to be installed near the various installations. These receptacles are to be emptied periodically and waste to be deposited in a vat for recovery or a dump (pit). This pit must be located at least 100m installations and in the event of presence of river with at least 150m. At the end of work, the pit is to be filled with ground up to the level of the original ground.

c. Setting out (implantation):

The Contractor is responsible for the setting out of the works and he is also responsible for the levels, alignments and dimensions of the works carried out according to indications of the setting out plan and the mass plan.

In the event of levelling or setting out error, the Contractor will be held to carry out at his expenses and whatever their importance all works necessary to the re-establishment of the buildings in their envisaged positions.

The Company will make all provisions consider necessary and remain responsible for the consequences of any error of measurement, whatever the origin of the plan and calculations. The project controller reserves the right to proceed to his expenses to routine checking of the various axes and elements of establishment or levelling of the works.

Article 7: Security and Fencing

Site installation here will entail the construction of a temporal fence round the project site to restrict direct entry of non-workers. It also involves the construction or allocation of a site office, store and base for workers.

Article 8: Preparatory Works

The minimal depth of the excavation trenches for foundation shall be at least 70cm, and depending on the soil bearing capacity. Where there is black vegetable soil or soil with low bearing capacity at the bottom of the trench, the contractor shall continue excavation up to a depth as will be approved by the Project Controller or the Project Engineer, after which the footings shall be dug from this level for a depth of at least 20cm. The excavations will be done manually and no concrete or mortar shall be

laid on the bottom of the trench without the acceptance of the trench bottom of excavation by the Project Engineer. The descriptive notice completes or confirms the indications on the execution plans. In the case of contradictions between the plans and the descriptive notice, the project team shall be contacted for examination, elaboration and conclusion. These technical specifications have as objective the definition of the consistence of works to be executed in accordance with plans and according to technical norms for the construction of building such as classrooms, toilets and extension of water of very short distance.

Construction phase

- **Execution Works**

The main activities that constitute the construction phase are:

- Clearing and cutting some wild tree on the road path
- Construction and moulding of the road ways
- Installation of drainage structures
- Regeneration of vegetation

Labour Intensive Method

The chosen company will make use of the labour intensive method to the maximum

- a) Clearing and cutting of wild trees on the path ways
- b) Excavation
- c) Shaping of stones
- d) Mixing of mortar

Quality and quantity control

It is important to note that the execution works involves the rehabilitation of the road and construction of drainage structures in the BAMEDA III council area. This means that the required appropriate methods in terms of quality and quantity control will have to be implemented.

Environmental considerations

a. Security

The contractor shall put up signboards to indicate that work is underway in the vicinity. He shall provide cover to third parties, his staff and employees in case an accident occurs during the works.

b. Disposal of waste material and cleaning of sites

This would be done in such a way not to affect the environment. There will be cleaning of the various work sites after the completion of works. The personnel of chosen company would be sensitised on the need for protection of the environment.

They will also be sensitised on the respect of the customs and tradition of the people and the dangers of HIV/AIDS and other related diseases

CUTTING DOWN OF TREES:

The works shall consist of the cutting down of trees of more than 25cm diameter and removing all the tree trunks along the road surface of the project and which has the possibility to fall and block the road circulation. This activity consists of cutting down, off-rooting and reconstruction of the gap of the cut tree.

BACKFILLING AND COMPACTING OF ROAD SURFACE WITH MATERIAL FROM BORROW PIT:

These works shall comprise of:

- the Provision of selected material (laterite) from an approved borrow pit;
- Spreading of the material on the road surface with the use of trucks and graders;
- Watering of the road surface containing the material and
- Compaction of the material with a cylinder compactor up to obtaining a compaction of 95%OPM and a thickness of 20cm.

The approval of the material and the borrow pits shall be done at least two (02) weeks before the start of this activity. At the end of this activity, the road surface should be moulded with a slope of 3% and shall present a convex (curved outwards) shape to avoid water stagnation and enable drainage of the water into the road side gutters for onward free flow evacuation.

GRADING AND COMPACTION OF ROAD SURFACE INCLUDING CLEANING OF EXISTING DITCHES AND OUTLETS:

This activity shall comprise:

- Grading the section of the road by scarification to at least 10cm and moulding;
- Watering the graded section and compacting with a cylinder compactor to obtain a compacity of 95% OPM;
- Cleaning of existing road side ordinary ditches and outlet to about 20m long out of the road surface.

At the end of this activity, the road surface should be moulded with a slope of 3% and shall present a convex (curved outwards) shape to avoid water stagnation and enable drainage of the water into the road side gutters for onward free flow evacuation. The cleaning of the existing ditches and outlets can be done mechanically or manually to remove all solid obstacles while providing a free flow slope of at least 5% in the ditches for water evacuation.

CREATION OF ROAD SIDE DITCHES AND OUTLETS:

This task shall consist of creating road side ordinary or earth ditches into existing ditches or into existing road side structures and creating outlets from ditches to about 20m long into the verges of the road.

This task shall be realized mechanically or manually depending on the area of work and outlets should be created at least at every 100m with a slope of at least 5% provided.

CONSTRUCTION OF RC BOX CULVERTS:

This task shall consist of re-establishing the water flow path of a crossing point by the setting up of a BOX culvert below the road surface. The culvert shall enable a normal flow with a gentle slope without water stagnation and would be done by a notified placement from the project controllers

MODE OF EXECUTION OF WORKS

Concrete Works.

The scope of concrete works shall include the following:

- Installation of concrete production units
- Procurement and delivery to site of cement, sand, aggregates and any other concrete production ingredients
- Setting up of temporal workshop and production of formwork elements
- Setting up of unit for iron bending
- Fixing of rods and divers embedded items
- Erection of formwork
- Production of concrete (batching)
- Casting of concrete
- Execution of surface finishes on concrete

Our prime quality objectives for the concrete works shall be to ensure that all design specifications are met, especially those relating to concrete strength and surface finishes.

To ensure that the specified physical characteristics of sand and aggregates are respected, all sand and aggregates to be used for concrete production shall be well selected.

The required concrete shall be produced on site. Concrete production on site will of course require stocking of sand, aggregates and cement on site. Within the space limitations on site, these concrete production ingredients shall be stockpiled on site in sufficient quantities to pre-empt any interruption of concrete works.

Once in place, the concrete shall be consolidated by means of simple vibration.

Formwork (COFFERING):

Material for formwork shall be wood. This shall be cut, shaped and assembled on site to the required forms and sizes. Simple conventional wooden formwork shall be used in the construction of the various concrete structural elements (columns, beams, etc.). These shall be fabricated *in-situ* and, lifted into position.

Reinforcement.

On the whole, reinforcement steel shall be cut and shaped using the simple conventional methods and tools encountered on ordinary construction sites.

EARTH WORKS

- . Provisions of selected material (laterite) from borrow pits;
- Backfilling/compaction with selected laterite (free from all vegetation and debris) in successive layers of 20cm.

The material for backfill of the earth blocks beside the culvert shall be in conformity with the same material for price n° 202 above and shall be compacted in successive layers of 20cm on the total length of the structure with a compacity rate of 95% OPM. The height of the backfill on the culvert after compaction shall be at least $10\text{cm} + \varnothing/2$. The profile connection of the road with the speed brake created by the earth block on the culvert shall not present a slope greater than 4%.

CONSTRUCTION OF BOX CULVERT HEADS OF MASONRY:

This activity shall consist of constructing inlet and/or outlet culvert heads with well shaped black basalt stone masonry and sand-cement mortar dosed at $400\text{kg}/\text{m}^3$ in order to ameliorate the flow rates of water in the structures. These heads shall be realized in masonry and sand-cement mortar and shall be in conformity with the plans provided, which are straight heads with side walls. A small slope of at least 2% shall be provided at the base or floor of the structure.

CONSTRUCTION OF BOX CULVERT MANHOLES OF MASONRY:

This activity shall consist of constructing inlet and/or outlet culvert manholes with well shaped black basalt stone masonry and sand-cement mortar dosed at $400\text{kg}/\text{m}^3$ in order to collect water coming from road side gutters and channel them into the crossing structures. These manholes shall be realized in masonry and sand-cement mortar and shall be in conformity with the plans provided, with approval from the project controllers. A small slope of at least 2% shall be provided at the base or floor of the structure.

ORIGIN OF MATERIALS

The necessary borrow sites shall be indicated by the supervisor after running identification tests on the materials.

If need be, the contractor may choose other borrow sites and submit their identification tests for the approval of the supervisor whose refusal will warrant that the contractor look for new borrow sites without claiming any compensation or using those indicated.

The contractor may start exploiting an identified quarry only if the supervising Engineer has carried out quality control and given his authorization.

In case of contradictory test results, the supervisor may ask the contractor to run further tests at his own cost.

The Supervisor may withdraw the authorization at any time once the quarry no longer provides good quality material. In that case, the contractor cannot claim any compensation.

Bush clearing, top soil removal and tree felling required for the exploitation of borrow sites shall be at the expense of the contractor and shall not be paid for as of right.

QUALITY OF MATERIALS

Laterite and Scoria (Pouzzolana)

The laterite or Pouzzolana required to fill the bridge shall be of selected material. It should be free of organic material and have a modified dry proctor density higher than 180 T/m³, a plasticity index (PI) of between 15 and 25 and particles smaller than 25 mm.

Qualities of the laterite or Pouzzolana shall be specified on the works site by the supervisor who may immediately accept or refuse exploitation of a deposit, a deposit area, or a heap of laterite or Pouzzolana that has bulked. If the contractor objects, the Contracting Authority may conduct control tests and/or ask an approved Laboratory to conduct the density and plasticity index tests mentioned above. And where the material does not conform to specifications, the contractor shall bear the cost. Otherwise, the project will take charge of it.

CONTROLE PHASE

The realization of works shall be programmed for at least eight (08) hours daily on week days from Monday to Saturdays except for Sundays and Public holidays, while the controllers shall supervise the execution of the works to ensure proper execution of the works and the respect of the norms of work. Site meetings shall be organised at least once a week (in a location provided by the Enterprise) with evaluations on the quality and quantity of the works produced and signed by the committee present. Site log books shall be provided by the Enterprise with a daily report of the works realized, the personnel on site and the equipment present on a daily bases. The controllers shall also be charge in the control of these site log books and shall note any observations or recommendations for the works realized daily.

During weekly site meetings, the controllers shall be the secretaries and shall preside over all the meetings while the representative (approved designated representative) of the Enterprise, shall take part OBLIGATORILLY, in all the meetings.

RECEPTION PHASE

The reception phase of the works will be done in strict respect of the terms of the contract. This will mean that before the technical reception of woks, the works director will make sure that all the works are completed and the site cleaned. He will participate in both the provisional and final reception of works.

N.B: THE CONTRACTOR SHALL BE RESPONSIBLE FOR ANY ERROR OF OMISSION OR WRONG INTERPRETATION OF THIS DOCUMENT

STUDIES OF THE MICRO-PROJECT

Site inventory and categorization of the micro-project

<i>Designation</i>	<i>Observation and Remarks</i>
The GPS coordinates	<ul style="list-style-type: none"> Start point(MORINO STORE): Longitude =630331 Latitude = 659430 Altitude =1299
Project category	The micro-project site falls under Category B1, which just requires simple mitigating measures of the environment.
Site topography	The site relief is fairly undulated with a 12% gradient in a low-lying area.
Project site vegetation	It is made up of a surrounding neighbourhood and palm trees.
Site pollution activities	There is no activity close to the project site that will pollute the environment;
Hygiene and sanitation	02-metallic garbage bins of 100-litres shall be provided for solid waste disposal
Soil	This soil is composed of colluviums laterite suitable for any strip foundation construction type;
Drainage	The site is well drained with 7% gradient;
Climate	The climate is warm with an average temperature of 29°C, humidity of 45% and an average annual rainfall of 2000mm.
Water course	three water courses
Wind	The project site is not windy (<100km/hour) due to the enclosed nature of the site by neighbourhood and eucalyptus trees, but the wind blows strong NS;

Table 1: Estimation of the socio-environmental impact of the micro-project

Poor drainage leading to creation of surface pole water	Provide drainage channels along the sides of the road to control surface runoff and dampness.
Risk of erosion due to excavation and clearing	Regenerate vegetation by planting carpet grass and some shade trees.
Littering of the road section with solid waste	02 metallic garbage cans of 100 litres shall be provided for solid waste disposal.

Duration of execution of the micro-project : four MONTHS	Probable date of beginning of the work:
--	---

Environmental management plan of the micro-project

PROTECTION OF THE ENVIRONMENT

SITE INSTALLATIONS

The contractor shall propose to the project manager, before the start of works, the places of his site installation and solicits by a verbal notification (with it mentioned on the report) the authorization of site installation.

The location of the installations should be situated out of sensitive areas to avoid, too much grass cutting, off rooting and cutting of trees. In the installation zone, pruning and cutting down of trees whose diameter above 1m from the ground level is greater than 20cm should be done with an authorization from the Supervisor.

The site should preview adequate drainage of water in its total surface area. The areas where machines are washed and repaired should be concreted with a pit to collect the oily and greasy waters. This repair and cleaning area should have a slope towards the pit and towards the centre of the platform to avoid polluted water from reaching bare ground.

At the end of works, the contractor will take all the necessary measures to keep the area in good state. The contractor should pack all his equipment including machines. He should demolish any fix installation, like foundation, concrete or metallic supports etc, demolishes the concreted area, disinfect the soil if it was contaminated. In general, he should put it back or near its original state. He is not permitted to abandon any equipment or machines on site or its environs.

Concerning where to deposit the demolished materials, the contractor should seek the authorization of the delegated project manager. These demolished materials will be covered by a layer of soil and protected from erosion:

After packing of equipment from the site, minutes will be established under the confirmations of the control mission, this will be joined to the minutes of works reception. The payment of the rest 30% of site installation will be done only after the presentation of these minutes.

REHABILITATION UP OF QUARRY, DEPOSITS AND BORROW PITS

The contractor should ask the authorizations previewed by the rules and regulations in use.

- Law n°001 of 16 April 2001 on mining code

- Decree no 2002/0110/pm of 26th march 2002 fixing the modalities of law no 001 of 16th April 2001 on mining code.

He shall take charge of all costs involve which include exploitation taxes and any compensation to land owners

In case of a new borrow pit sit in needed the contractor is oblige to take authorization from the delegated project manager.(verbal authorization but mention in works report)

The following criteria should be respected

- Distances of the site should be at least 30 m from the road.
- Distance of the site should be at least 100 m from natural flowing water or water plan
- Distances of the site should be at last 100 m from residents.
- surface to be exploited should be limited to a strict minimum
- Quality of trees (on the project manager's judgment) should be preserved and protected

Areas where deposition will be done should be chosen such that it should not disturb water flows and protected from erosion.

The contractor should also take an authorization for deposition from the delegated project owner (verbal note obligatory and stated in the works report).

If the proposed site, exploitation method, and rehabilitations preview are not in conformity with environmental exigencies, the delegated project Manager would not approve its use and the contractor should propose other sites or modify exploitation method or propose other rehabilitation methods conforming to prescriptions without the contractor claiming any indemnities.

The contractor will bear all the costs of exploitation of all borrow pit sites especially rehabilitation up and maintaining the access. It also includes clearing, deforestation, removal of undesirable soil,, or humus soil and disposing them off the limits of the burrow pit, including all maintenance works concerning the protection of the environment prescribed.

The contractor will execute all works necessary to keep the site in its original state. These include:
The spreading of coverage material and consequently humus soil to facilitate water percolation, vegetative growth and afforestations if prescribed.

Re-establishment of natural water flow, upstream and arrangement of retaining pits.

The suppression of dumps on the site by spreading and dissimulating big rock blocks.

After re-instating the borrow pit area to conformity with prescription, minutes will be written which must be presented before any payment.

SCHEDULE OF UNIT PRICES

SCHEDULE OF UNIT PRICES: THE CONSTRUCTION AND OPENING OF ROAD AT UPPER BAYELLEQUARTER AND CONSTRUCTION OF 11 RC BOX CULVERTS ALONG THE ROAD (LENGHT = 750m)			
N°	DESIGNATION	U.P. in figs	U.P. IN WORDS
LOT 100	SITE PREPARATION AND STUDIES		
101	Site installation and geotechnical studies		
	This lump sum price include the cost of:		
	Preparing the site of equipment park and the project base of the enterprise;		
	Carrying out geotechnical penetrometre Studies relative to the construction of the the bridge;		
	Provide and install 02 project information boards at each end of the project site;		
	A lump sum cost		
102	Mobilisation and demobilisation of equipment		
	This lump sum price include the cost of:		
	The cost of transporting all the equipment to the site ;		
	Mobilisation of personnel;		
	Removal of all the equipment from site at the end of the project		
	A lump sum cost		
LOT 200	EARTHWORKS		
201	bulldozing		
	This price per unit include the cost of		
	bulldozing and clearing all grass and debris including any tree that is found on the stretch of road The cutting down of trees of more than 25cm diameter and removing all the tree trucks along the road surface of the project		
	A unit cost		
202	mise en forme		
	This price per Km of road includes the cost of:		
	Grading the section of the road by scarification and moulding;		

	<p>Cleaning of existing road side ordinary ditches and outlet to about 20m long</p> <p>A kilometer (km) cost</p>		
203	<p>placing of surface coarse</p> <p>This price per cubic metre include the cost of</p> <p>Provision of selected material(laterite) from an approved borrow pit</p> <p>Compaction of the material upto obtaining a compaction of 95%OPM in successive layers of 20cm;</p> <p>A cubic meter (m3) cost</p>		
LOT 300	DRAINAGE WORKS-STRUCTURES		
301	<p>construction and installation of 11 box culverts</p> <p>This price per metre length includes the cost of:</p> <p>construction of 100cmx100cm RC box culverts , Digging or excavation of all trenches right to the resistant soil; Provision of selected material(laterite) from borrow, the complete construction of RC box culverts with dimensions as specified in the CCTP</p> <p>A meter length (ml) cost.....</p>		
302	<p>Construction of masonry culvert heads including all accessories</p> <p>This price per Km of road includes the cost of:</p> <p>construction of masonry head culverts with cement mortar dosed at 350kg/m3</p> <p>A kilometer (km) cost</p>		
303	<p>Construction of masonry gutters</p> <p>This price per unit is the cost of:</p> <p>Constructing masonry gutters with black stone masonry with respect to the plan dosed at 350kg/m3</p> <p>A unit(u) cost</p>		
401	Supply and install Labelisation boards		

	This price per unit is the cost of:		
	Constructing culvert manholes with black stone masonry with respect to the plan dosed at 350kg/m3		
	A unit(u) cost		
501	Sensitization of the management committee on the maintainance and risk hazards/planting of twenty (20) trees		
	This price per unit is the cost of:		
	Mobilisation of personnel and purchasing and planting of twenty environmental friendly trees		
	A unit (u) cost		

DETAIL PRICE BREAKDOWN

N° Price	Description of activities	Daily out put	Total Quantity:	Unit	Activities Duration (days)
A - PERSONNEL	Category	number	Daily Salary	Paid Man-days	Amount
					-
			Total A		
B - EQUIPMENT	Type	number	daily rate	Days billed	Amount
			Total B		
C - MATERIALS	Type	unit	Unit price	Quantity	Amount
			Total C		
D	TOTAL Direct cost		A + B + C		
E	General site expenses		D x 10%		
F	General head office expenses		D x 05%		
G	Cost price		D + E +F		
H	Risk and profit		G x 10%		
I	Total cost excluding taxes		G + H		
J	UNIT PRICE WITHOUT TAX		I/QTY		

MODEL OF ENGAGEMENT OF THE TENDERER

ENGAGEMENT OF THE TENDERER

I the undersigned, _____, acting by virtue of powers conferred on me, on behalf of the company, _____ with Headquarters situated at _____ Town,

After having taken knowledge of all the parts of the Request for Quotation Documents **N°** _____ for

Subject to me and commits me to carry out the aforementioned Contract in accordance with

The conditions of the Particular Payment of the Request for Quotation, the Book of the Particular Technical specifications and the Book of the Particular Administrative Clauses, in particular the quantitative and qualitative confirmation of work, the respect of the deadlines, the guarantees and the insurance.

I commit myself moreover to ensure the recording and paying the forwarding costs of the contractual parts.

I declare taking to have taken perfect knowledge of the decree n° 33/CAB/PM of February 13 2007 putting the general Administrative clauses applicable to the Contracts of public works and works.

I confirm my agreement on the terms of the Special Administrative Clauses (Draft contract) and join the initialled copy of the aforesaid document to my offer.

I declare moreover that I remain committed by the present tender during a ninety (90) days deadline as from the date of opening of the folds.

Done at _____, the _____

Read and approved

The CONTRACTOR

MITIGATION OF RISKS CLAUSES ON THE ENVIRONMENT

DEFINITION

These standard clauses constitute the Environmental Regulations relating to the construction works contracts and which will have to be inserted in the tender documents of the enterprise within the framework of the PNDP2.

Thus, every enterprise pre-selected for a works contract will have to implement not only measures aimed at mitigating the socio-environmental impacts of the micro-projects but also environmental and social clauses outlined below. It should be stressed that these clauses apply to all types of micro-projects, the enterprise as well as all sub-contractors or dealers.

These measurements include:

- A reduction in the raising of dust particles at the work site in order to protect the health of the beneficiary population and site workers, by regular watering of the site, or the adoption of an appropriate calendar;
- A Reduction in sound (noise) effects due to the movements of the equipment and machines within the construction site;
- Non obstruction of the existing rivers by works, or the deposit of waste in the river channel;
- Putting in place a management plan for oils, fuel, lubricants and other dangerous products. This plan will have to include the recuperation of the above mentioned products and their transfer to specialized companies for treatment;
- Automatic stop of works in the event of discovering of an archaeological or historical artefact, then report immediately to the services of the Ministry of Culture;
- Prohibition to transport or drive out game, hunting and non-timber forest products by the personnel of the building site;
- Put at the disposal of the working site adequate equipment for potable water and domestic use water;
- Priority recruitment for Jobbing labour, as well as the use of Jobbing materials;
- Putting of warning Signs (sign boards) at building site during and after work; putting speed limits warning signs as well in order to protect the safety and health of the resident population and of site workers;
- The wearing of appropriate equipment & attire (e.g. work clothes) by site workers.

- Restoring (*putting back to its original nature*) gradually installations at building site at the end of works;
- Organizing information and sensitizing campaigns for site workers and the beneficiary populations, on medical risks, risks of accidents, and on the impacts of poaching.

According to the various phases of work, under the control of contracting authority-Mayor (Council development officer) assisted by the Jobbing representatives of the MINEP and the PNDP, the provisions here-in will have to be considered or implemented by the contractor.

Article II. Starting of works and sensitization of stakeholders

Before the effective start of works, the company or enterprise must prepare an environmental action plan specifying the whole of environmental measures to be implemented, as well as rules of procedures mentioning in a specific way the safety requirements and in particular the wearing of appropriate equipment (work clothes) and speed limit warning signs. Furthermore, these internal rules and regulations will have to prescribe the prohibition of alcohol consumption during working hours, to transport or hunt game, to abusively use wood for fuel, as well as the sensitization of the personnel on the dangers of the STI/SIDA, the respect of the customs and habits of the populations of the area. These rules must be pasted within the company.

On the other hand, an information and sensitization campaign of the personnel and residents will have thus to be organized beforehand and their attention will have to be drawn to all these aspects, including the calendar of execution, the employment opportunities. In particular, these stakeholders should be informed on the reasons for the choice of the site for the Jobbingization of the micro-project as well as the environmental action plan. This sensitization campaign will have to be re-lunched during the execution of the work.

Article III. Setting up a building site

a) Jobbingization

The importance of setting up a site is determined by the volume and the nature of work to be realized, the number of workmen or labourers, the number and the type of machines. The plan of setting up a building site will have to take into account management and protection measures.

In this regard, the selected site must be at a distance from at least:

- 50 m off the road.
- 100m off a lake or river.

- 100m off habitation (dwelling);

The site will have to be selected in order to limit clearing, the pulling up of shrubs or bushes and the demolition of the trees. The valuable trees will be preserved and protected.

The site must be selected away from sensitive zones particularly the marshy zones, the wetlands, sacred zones and the hillsides. Lastly, the site should envisage an adequate Water drainage on the whole of its surface

b) Equipment

The office and housing area in the working site for the personnel must be equipped with sanitary facilities (latrines, septic tanks, absorbing wells, wash-hand basins and showers) according to the number of the work force. The water tanks (reservoir) will have to be installed and the quantity of water must be adequate with the needs. Adequate drainage must protect the installations.

c) Management of solid waste and liquids

Receptacles (*containers*) to receive waste are to be installed near the various installations. These receptacles are to be emptied periodically and the waste deposited in a garbage can for recuperation by the Council or in a dumping pit. This pit must be located at least 100m from the installations and in case of a river at least 150m away. At the end of work the pit is to be filled (restored) with soil up to the level of the original soil.

The pads (apartments) for servicing and washing of the machines will have to be concreted and equipped with a sump - *container into which a liquid that is not needed can flow*) for recuperation of oils and greases. Worn oils or drainage oil are to be stored in barrels and kept in a secured place while waiting to be moved to a specialized centres for treatment. It is the same process for oil filters, batteries and other toxic waste.

Article IV. Recruitment of the site workers, health and safety

The contractor is expected to make use of in the most possible way Jobbing labour in the area or zone where work is to be realized or executed. Failing to find the qualified personnel on the spot, he is authorized to recruit labour in the wider working area.

Apart from the training and information for the personnel on the aspects mentioned above (point 1), the contractor must provide his workmen with the necessary safety and adequate equipment, according to the duty post – anti-dust to prevent dust particles, anti-noise helmet, safety shoes, boots, glove, glasses etc.

During the works, mobile and fixed signs or notice will be put in place in order to ensure the safety of the staff and resident population. The company or enterprise will

carry out routine watering of the site in order to limit dust particles. He will also take care of the speed limits of the various vehicles and machines (less than 40 Km/h). In the same way, he will have to take care that all the temporary deviations are identified in collaboration with the resident population, and the deviations do not affect the sensitive zones.

Article V. Opening up and exploitation of quarries and borrowed zones

a) Opening up and exploitation:

The opening up and the use of quarries are regulated by:

- Law 64/LF/3 of April 6, 1964;
- Decree 64/Lf-163 of May 26, 1964,
- Ordinance 74/2 of July 6, 1974,
- Law 76/14 of July 8, 1976 modified and supplemented by that of NO 90/021 of August 10, 1990,
- Decree 88/772 of May 16, 1988 modified by decree 89/674 of April 13, 1989,
- Decree 90/1477 of November 9, 1990.

The quarries exploited on the public lands are subjected to authorization. The quarries exploited on private lands are subjected to declaration.

The contractor will have to ask the authorizations envisaged by the texts and for payments in force and will take responsibility for all his related expenses, including the expenses for an eventual compensation of the owner or proprietor.

The contractor will have to present a programme (Plan) for exploitation of the quarry according to the volume to be extracted for works and the reserves.

If the exploitation of the quarry requires noise (*sound, blast*), the residents should consult the exploitation schedules, and the generated noise will not have to exceed 90 decibels at the level of the residents.

The spot for quarry deposits will have to be selected so as not to obstruct the run-off water and will have to be protected from erosion. The contractor will have to obtain controller's approval for the quarry deposits spot.

b) Bringing back the site to initial or original state (Restoration of the site) & withdrawal from the site

At the end of works, the site will have to be brought back to its initial or original state. In this regard, installations necessary hereafter will have to be carried out:

- The adjusting of opening materials, then the levelling of the site and in particular levelling of the top soils in order to facilitate the infiltration of water, re-planting of grass and trees as the case may be,

- Restoration of the former natural flows,
- Removal of the dilapidated aspect of the site,
- Fitting up (either through re-filling) of pits in order to avoid the erosion of the degraded soil,
- Restoration of the pit and recuperation of surface waters and conservation of the slope, if the quarry or the borrowed zone can be used for other uses - livestock, playgrounds for the inhabitants, etc.

As regards the working site, the contractor will complete all necessary work to restore the site (bringing the site to its original state). The contractor will have to take away all his material & machines. He is not supposed to abandon any equipment nor materials on the site, or at the surroundings, without prior notice of the controller. This restoration of the site relates to all its deviations and contours (e.g. foot paths etc) set up during the works.

It is desirable that the sites should be restored in a progressive way.

Article VI. Clearing of undergrowth and pruning

Clearing of undergrowth and pruning of the immediate surroundings of the work in order to improve on the sunning conditions of the earth roads and also to improve on the visibility.

As regards pruning, all the branches overhanging the platform will be cut vertically passing by the clearing limit. All the trees will be cut down overhanging the immediate surroundings and threatening to fall on the work or to impede circulation after a tornado.

The question on clearing of the undergrowth consists of cutting at ground level without uprooting the vegetation.

All trees and shrubs at the entrance and exit of the works (bridges, etc.) will be uprooted so as to facilitate the running of water and to facilitate the regular inspections of the works.

Lastly, it is requested from the contractor to identify as from the starting of works, the buyers (middlemen) of the aforementioned waste among the residents (fodder for the cattle, for construction, fuel wood, etc). It is prohibited in the areas of the Extreme North and North to burn on the spot wastes vegetation that have been cut.

For other regions, if the burning of waste is authorized by the Controller, the contractor must take additional precautions by increasing for example the width of the safety belts around waste to burn, and prevent the residues from being an obstacle to the running off of water.

Article VII. Management of water Resources

The contractor will have to avoid any conflict which can result from the use of water resources, in particular in the Northern regions of Cameroon.

Thus, for these water needs or requirements (watering of area around the works), the taking away, will have to be done after obtaining the necessary authorization from the competent services (Regional Delegation of Public Works) and in consultation with the beneficiary populations.

In any case, the company or enterprise will have to avoid taking away important items in seasonal rivers, likely to stop the water satisfaction needs of the residents or beneficiary population. In addition, he will have to avoid intervening in sensitive zones; avoid introducing various pollutants resulting from washing or draining of vehicles oil and machines. Lastly, he will not have to undertake the installation of equipment that can stop the flowing of rivers, without prior notice of the competent Services.

Article III. Compensation for the damages caused to third parties

It can happen that the company hurts an individual in a deliberate or accidental manner (destruction of crops, habitat, etc). If this wrong is not taken into account by the project owner or contracting authority, it will have to be compensated with the expenses from the company and satisfactorily to the party. On the other hand, he will have to issue a certificate of compensation to him, in order to avoid any other later complaints.

PLANS AND DRAWINGS

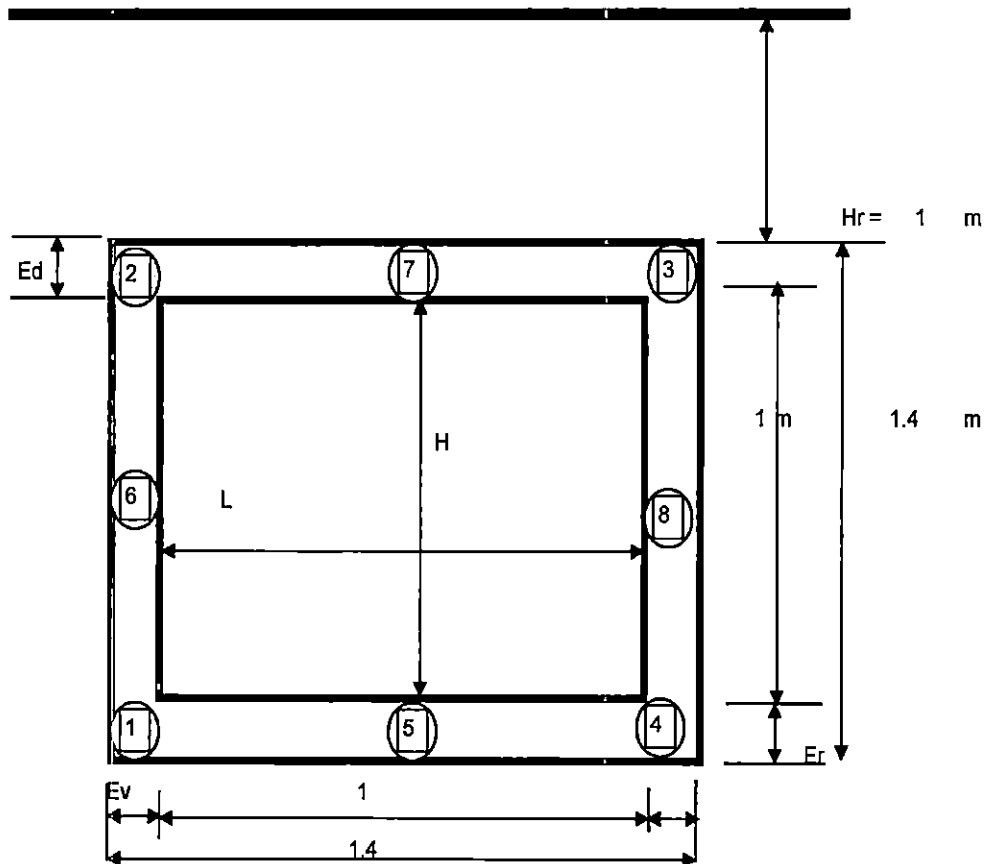

LES DONNEES DU CALCUL

Position	Denomination	Unité	Valeur	
1	coefficient numerique (A)		0.33	Voir le rapport géotechnique
2	Masse volumique des terres (&)	daN/m3	2100	
3	Resistance admissible du sol R	MPa	0.1	
4	coefficient de frottement interne f		0.32	
DIMENSIONS DU MUR				
5	Longeur du dalot	L _{ong}	m	6.4
6	Hauteur du dalot	H	m	1.0
7	Largeur du dalot	L	m	1.0
8	Epaisseur de la dalle	Ed	m	0.2
9	Epaisseur des voiles	Ev	m	0.2
10	Epaisseur du radier	Er	m	0.2
11	Hauteur remblai	Hr	m	1
12	CHARGES			
Bc	Nombre d'essieux pouvant se retrouver sur le dalot simultanement			
	Essieux 12T (n1)	U	4	
	Essieux de 6T (n2)	U	0	
Bt	Nombre d'essieux pouvant se retrouver sur le dalot simultanement			
	Essieux 16T (n3)	U	4	

13 CARACTERISTIQUES DU BETON

Resistance à la compression f_{c28}	MPa	25
$f_{bu} = (f_{c28} \cdot 0,85) / 1,5$	MPa	14.17
Contrainte tangentielle limite	MPa	1,25
poids spécifique du béton γ_b	daN/m ³	2500

14 CARACTERISTIQUE DES ARMATURES

Acier FE40 f_e	Mpa	400
$f_s = f_e / 1,15$		347.83

-Hypothèse sur les charges sur chaussée

Les charges prises en compte pour le dimensionnement des différents éléments sont :

- Le système de chargement B
 - le camion type Bc
 - les essieux tandem Bt
- Le système de chargement A

NB: Pour des longueurs chargées inférieures à 10 m le système de chargement A ne sera pas envisagé dans les calculs (confère fascicule 61 charges pont chap premier)

Le dalot étant sous remblai il n'est pas nécessaire de calculer le coefficient de majoration dynamique car les vibrations sont absorbées par le remblai

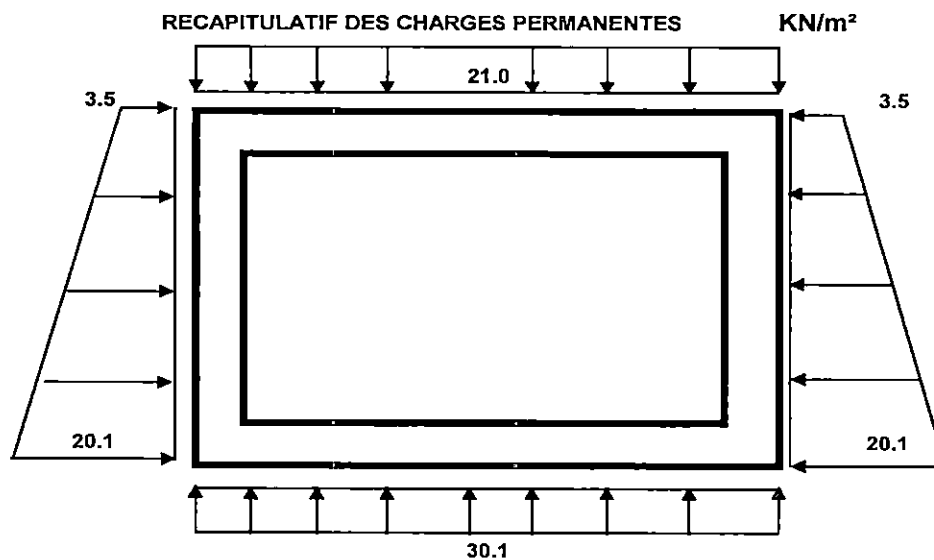

B - SURCHARGES

B1 - cas de chargement Bc

Schéma de repartition des surcharges sur le dalot pour les essieux arrière du système Bc

